

PRODUCT DESCRIPTION

Multifunctional epoxy primer for grounding, filling or intercoating, used as a protection against osmosis and corrosion. The two-component epoxy primer is in a spray can, which makes its use very easy and quick. Can be applied below and above waterline.

PRODUCT INFORMATION

SURFACE TYPE	laminate, steel, aluminum, paints and varnishes 2K (In good condition and sanded)
COLOR	white
GLOSS	mat
VOLUME SOLIDS	Not applicable
DENSITY	Not applicable
VOC	690g/l
MIXING RATIO	Not applicable
METHODE OF APPLICATION	spray

INSTRUCTION FOR USE

SURFACE PREPARATION

Laminate – salt and other contaminations remove with pressurized fresh water after that wait until surface dry. Next step is to sand surface by abrasive paper P100-P240. Remove dust and degrease surface using Sea-Line Cleaner.

Steel – salt and other contaminations wash with water under pressure. Wait till dry. Clean the surface with abrasive steam to the degree of Sa 2,5. On small surface use angle grinder. Remove dust and degrease surface using Sea-Line Cleaner.

Aluminum- sand surface with P120. Remove any corrosion. Rinse surface thoroughly with 10% ammonia solution. Start painting no later than 6 hours after finishing grinding and cleaning.

PRODUCT PREPARATION Product is delivered in spray can. See instruction below on how to use it.

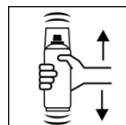

Shake can for 2 minutes, sound of moving ball must be heard from the packing, only this allows proper mixing.

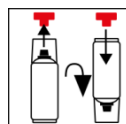

Remove the red pushbutton from the cap. Turn can 180° and fit pushbutton onto the pin in the base of the can.

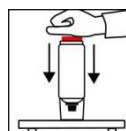

When can is upside down placed on a firm surface, press red pushbutton all the way in, with the palm of your hand.



After triggering, one more time shake can for 2 minutes, you must hear sound of moving ball from the packing.

Technical Data Sheet

EPOXY PRIMER 2K MULTIFUNCTIONAL SPRAY



APPLICATION

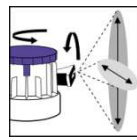

Adjust the nozzle by fitting force and way of spray to requested parameters of application

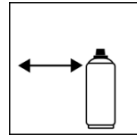

Spray distance: 10 ~ 20 cm

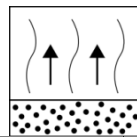

Overcoating interval, approx 5-10 minutes

Number of coats 2-4 layers (Total film thickness 200 µm DTF)

Pot life about 48 h in 20°C, relative humidity approx. 40-50%.

NOTICE The processing time depends on the ambient temperature. Higher temperatures reduce the pot life, lower temperatures will prolong it.

Do not process below room temperature 15~25°C.

CURING INFORMATION

Dust Dry	Touch Dry	Dry to sand	Fully hardened
1,5 h	3-5 h	24 h	7 days

The given times must be considered as a guideline only. The actual drying time may be longer or shorter depending on film thickness, ventilation, humidity etc. The definition of the drying times is related to DIN 53150

IMPORTANT NOTES

During application process air temperature should be at least 18-25°C, humidity 40-50%. After activation product should be kept in room temperature 15-25°C.

Do not apply Epoxy Primer 2K on one pack products. Avoid painting in direct sunlight. For degreasing use Sea-Line Cleaner.

Maximum primer recoating without standing primer is applied only when the surface is free from chalking and other contamination. If the primer coating was exposed to direct sunlight, it must be clean and sanded, removal of the top layer will provide better adhesion.

Immersion should be done only after when the last layer of primer and antifouling paint have hardened.

After painting, turn the can upside down and spray the valve until empty. The completely empty spray can, disposed in the recycling waste container. Cans with hardened material must be disposed as a special waste.

Technical Data Sheet

EPOXY PRIMER 2K MULTIFUNCTIONAL SPRAY



FURTHER WORKS After hardening it is recommended to sand surface using abrasive paper P240-P400
Sea-Line Epoxy Primer 2K Spray can be finished with:
epoxy system
polyurethane 2K paint and varnish
antifouling paints

STORAGE AND SAFETY INFORMATION

SHELF LIFE 36 months from production date

STORAGE Not activated product should be stored in tightly sealed containers, in a temperature 15-25°C and humidity 60%, away from sources of fire, heat and sunlight. Can should be stored and transported in vertical position.

HSE CONDITIONS Please follow safety instructions from the Safety Data Sheet and follow workplace safety laws. The general rule is to avoid contact of product with the skin and eyes. When using the product in a small, closed spaces you must provide forced ventilation. It is also recommended that you protect your respiratory system, eyes, and skin. Special care should be taken in the area of fire protection and explosion hazards.

DISCLAIMER All data in this document have been prepared for informational purpose only. We can not take responsibility for the results of user actions over which we have no control. The user is responsible for making the control sample and determining the suitability of the product for specific, individual applications. Company Troton Sp. z o.o. does not take responsibility for any damage, or loss of profits associated with the improper use of the products. All information is based on scrupulous laboratory research and many years of experience. Our position of market leadership does not free us from constant quality control of our products. However, we do not accept responsibility for the effects of improper use or storage of our products, or the effects of using our products in any way contrary to the standard of good workmanship.

QUALITY GUARANTEE Production, quality control and the realization of deliveries fulfill the demands of ISO 9001 and 14001 standards.